

ORDERING CODE

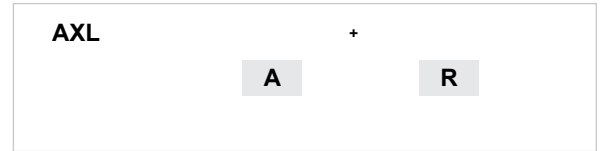

PROJECT INFO

TYPE

DATE

QUANTITY

LIGHT LOSS FACTORS

	OUTPUT	LED CCT	CRI
BASELINE	LH	4000K	80+ CRI
	LS - 50%	3500K - 97%	90+ CRI - 80%
		3000K - 93%	

PERFORMANCE AT 4000K

	LENS	NOMINAL LUMEN OUTPUT		INPUT WATTS	EFFICACY
OUTPUT		INDIRECT	DIRECT		
High	Dust Cover	843 lm/ft	N/A	9.5 W/ft	89 lm/W
	a•cirrus	648 lm/ft	N/A	9.5 W/ft	68 lm/W
	a•cirrus	N/A	667 lm/ft	9.5 W/ft	70 lm/W
Standard	Dust Cover	421 lm/ft	N/A	4.75 W/ft	89 lm/W
	a•cirrus	324 lm/ft	N/A	4.75 W/ft	68 lm/W
	a•cirrus	N/A	335 lm/ft	5 W/ft	71 lm/W

Custom tuned output available from 25% to 125% of high output. Please consult factory for custom lumen output and wattage.

MOUNTING OPTIONS

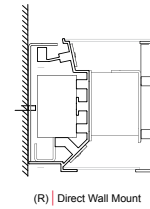

AXL		+				
SERIES	LENGTH	OUTPUT		LED CCT	VOLTAGE	INDIRECT OPTICS
AXL	_ Nominal Length <small>Specify in feet to the nearest foot (i.e. 12)</small>	ILS Indirect LED Standard Output ILH Indirect LED High Output IC_ Indirect LED Custom Output* - No Upper Board (some indirect light) + DLS Direct LED Standard Output DLH Direct LED High Output DC_ Direct LED Custom Output* - No Lower Board (some direct light) <small>*Available from 25% to 125% of LED High Output</small>		30 3000K 35 3500K 40 4000K	U Universal 120V - 277V 3 347V	D Dust Cover A a•cirrus™ lens

A		R			
DIRECT OPTICS	FASCIA	MOUNTING	FINISH	CIRCUITING	DIMMING
A a•cirrus™ lens	FL Flush HN Overhang Square HS Overhang Curved	R Wall Bracket	T a•lightanium™ W Satin White B Satin Black O_ Other* <small>*Specify RAL#</small>	1 Single Circuit 2 Multi-Circuit* M Other Multi-Circuit** <small>**Separate uplight and downlight circuits **Submit multi-circuiting requirements</small>	D Standard 0-10 dimming* D1 Lutron Eco H series (LDE1) D3 Other Dimming** <small>*Dimming to 1% stated for standard 0-10v dimming **Specify model/series</small>

EMERGENCY	OPTIONS
EC Emergency - circuited E_ Emergency - battery*	N New York City Code CRI 90+ CRI

*Factory-installed emergency battery pack: ILB-SL-CP12 (1200lm for 90min). Specify desired quantity of batteries. Not available on fixtures < 4' length. Not available for 347V. See technical data for more information.